



Vertical Planters, New Street, Huddersfield Town Centre

Client: Kirklees Council

Three 12 mtrs tall vertical planters created by artist Tim Ward have their own distinct themes; the first planter's theme is Contours, with the lattice structure representing the contours and topography of Huddersfield, the second's theme is Waterways and the third is Commerce with thread patterns representing the rich textile history.

Cllr Graham Turner, Cabinet member for growth and regeneration, said: "It's great to see work continue on New Street with the addition of these planters specifically designed for the area by artist Tim Ward. Not only are these planters going to add some greenery to our town centre but they also bring with them art and culture which will only be celebrated further with the embossed poem by Poet Laureate Simon Armitage. Through the Huddersfield Blueprint, the development of New Street is bringing a new energy to the town centre that will both increase footfall and, in turn, generate business growth."

Leaf Columns Sculpture Client: Test Valley Council

Artist Tim Ward developed the patterns and nature motifs for these columns and steel bench during design sessions with schools and local community so that the sculpture located outside the Community Centre would celebrate the biodiversity of the local woodland areas.

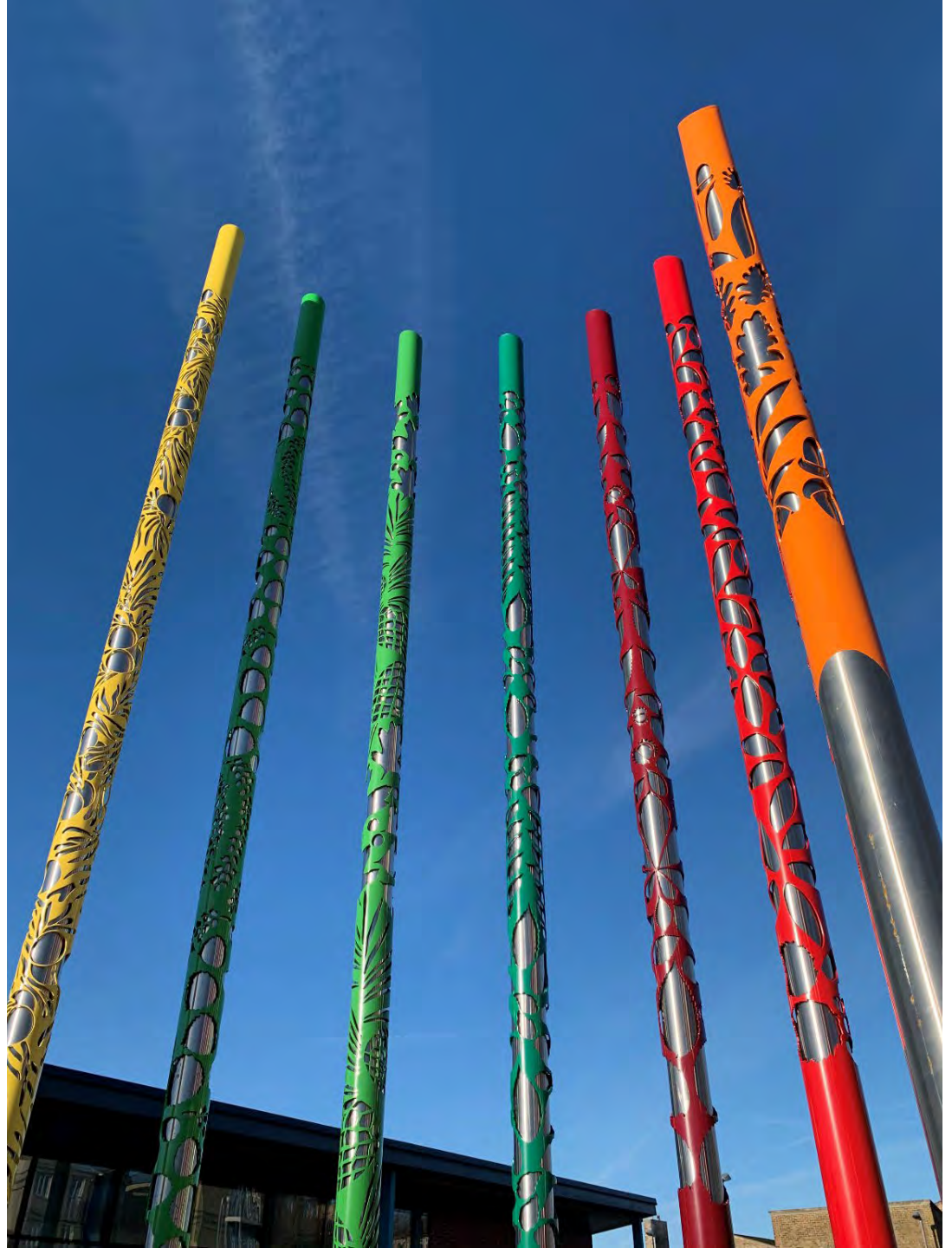



Leaf Columns Sculpture & Hoops, Picket Twenty, Andover

Client: Test Valley Council

The 'Leaf Columns' sculpture are located outside the Picket Twenty Community Centre consisted of eight vertical tubes sweeping down in an arc curve to decorative seating at the base. Laser cut leaf patterns representing the trees found in the nearby ancient woodland of Harewood Forest and the Year Group Classes of nearby Primary School Pilgrim's Cross. Nearby Harewood Common comprises of nearly 10 Hectares of chalk grassland rich in wildlife. The laser cut tops of the tubes are in summer & autumn colours.

In the nearby Play Park, Tim designed a series of colourful hoop arches ranging in height up to 2.7mtrs high represents the fun of children's games, as well as sports where hoops are used for physical fitness and rhythmic gymnastics.





‘Healthy Living’ Markers, Landimore Park, Hardingstone Client: Stonewater & Tilia Homes

Artist Tim Ward created these 2.5mtrs tall Waymarkers as part of the public art on the new housing development at Landimore Park, Hardingstone is a series of ‘Healthy Living’ Markers with decorative laser cut ‘wildflowers’ artwork and maps of local walks, footpaths and bridle ways around Hardingstone. The Markers are doubled sided with the perforated artwork visible on both sides and the opposite sides can have information panels relating to local heritage, wildlife, fauna and flora.



Queen Elizabeth II Memorial Opening Event in Hendon Park
Client: Barnet Council

The Queen Elizabeth II Commemoration Gateway at Hendon Park in London opened on May 10, 2024. The twin panels created by artist Tim Ward at the entrance to the park were originally created to celebrate the Queen's Diamond Jubilee but were reimagined after her death in September 2022 to honour her life and reign. The panels were funded by local individuals and institutions.



Queen Elizabeth II Memorial in Hendon Park

Client: Barnet Council

2No. Stainless Steel Entrance Panels that celebrate
the life of our late Monarch

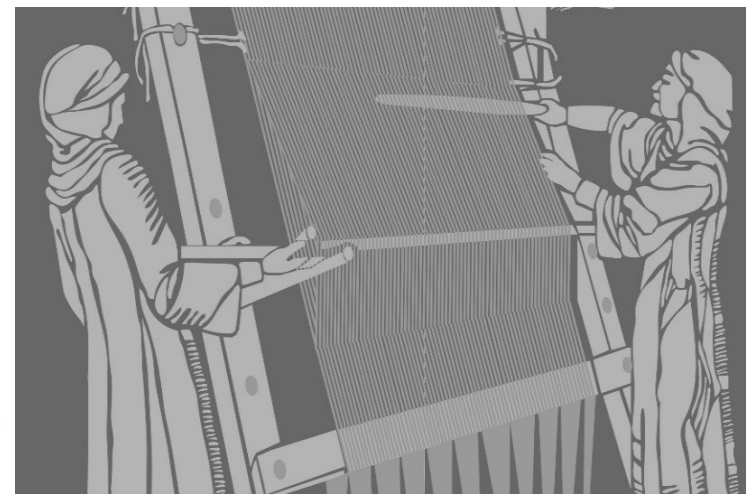

Clarendon Quarter Archaeology Themed Screens, Queen Street Hoarding, Oxford Town Centre Client: Lothbury Investment Management

The artwork was created by artist Tim Ward as part of the new Clarendon Quarter Oxford Development aims to inform and celebrate the site's unique social and retail heritage. The artwork relates to an archaeological studies carried out at the Clarendon site when several medieval artefacts were discovered relating to drapery and cordwainery (shoemaking). These, along with other medieval artisan trades, were key components to the early economic growth of the pre-University town of Oxford. The Screens received an Oxford Preservation Trust Award 2024.



Torch Sculpture, Urban Park Andover

Client: Test Valley Council

A 9.5mtr tall landmark sculpture for the Urban Park with playing fields for football, cricket and other sports.

The 'Torch' Sculpture represents a symbol of hope that guides, like a signal fire of old on a hill, of flaming tower or pole, people to the Urban Park. The idea for the Olympic torch was derived from ancient Greece, where a sacred fire was kept burning throughout the celebration of the ancient Olympics on the altar of the sanctuary of Hestia. During the build-up to the London 2012 Olympic Games was processed through the Picket Twenty Urban Park. The Torch design takes the form of sweeping 'movement' curves with reflective materials and kinetic elements.

The main structure is fabricated in 316 marine grade stainless steel with the internal areas in colours red and orange. The lower column has laser cut figures representing sports activities and semi-circular steel benches.

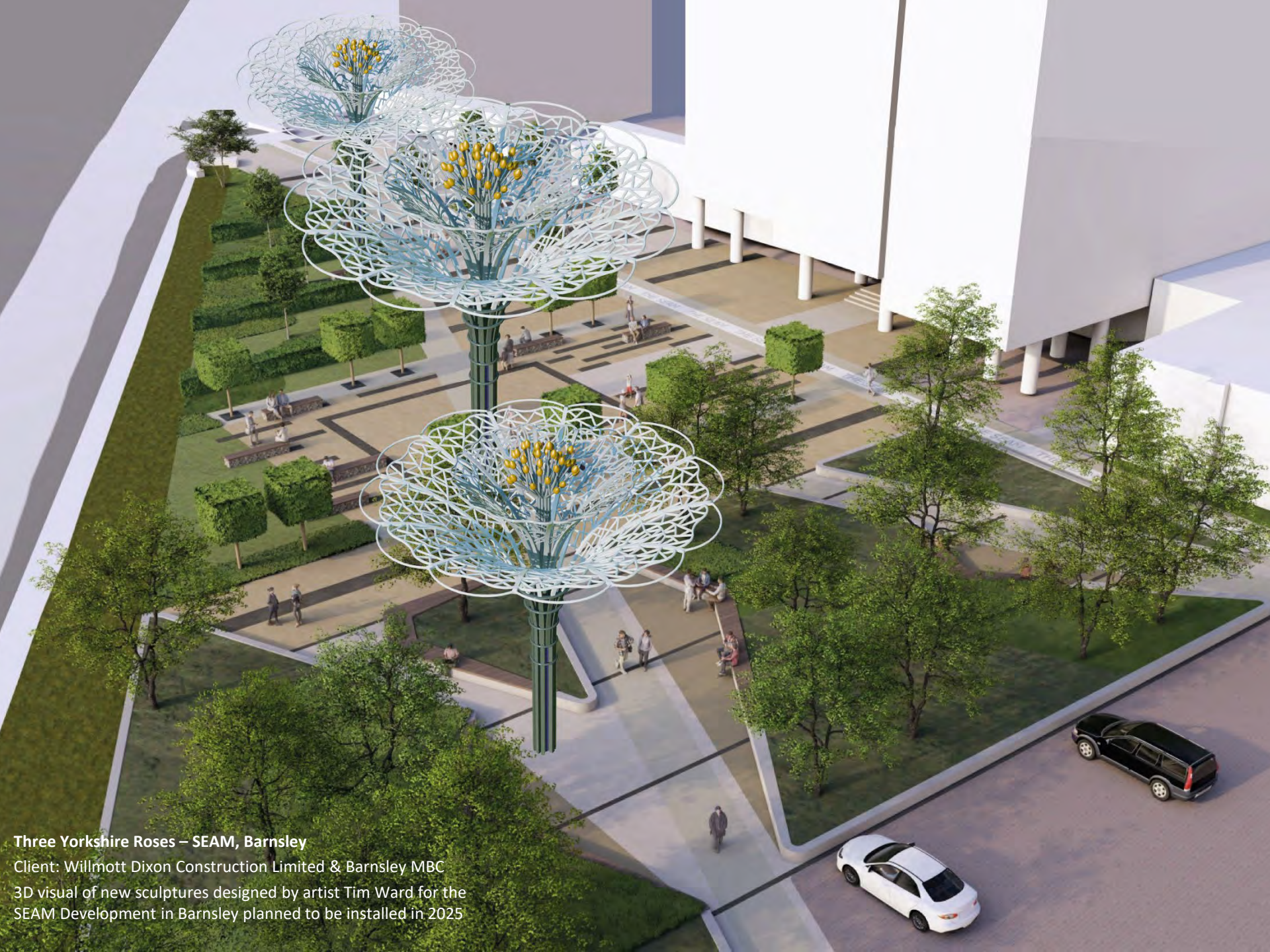

Three Yorkshire Roses – SEAM, Barnsley
Client: Willmott Dixon Construction Limited & Barnsley MBC
3D visual of new sculptures designed by artist Tim Ward for the
SEAM Development in Barnsley planned to be installed in 2025



circling **THE**
square

Artist Tim Ward

Circling the Square Ltd

28 Hills Road, Buckhurst Hill, Essex IG9 5RS

Tel: 07763 060759

Email: info@circlingthesquare.com

Websites: www.circlingthesquare.com
www.artworkersguild.org/member/timward/